

Befestigungen zu Höhenverkettung

NG4-Mini®, NG6

ZYLINDERSCHRAUBE M5xL

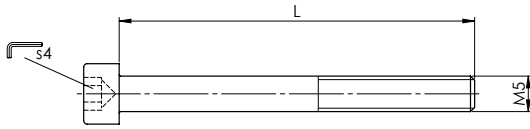

HALSMUTTER M5

Art. Nr. 154.7402

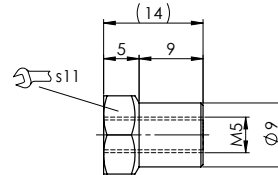

Anzugdrehmoment: 5.5Nm

ZYLINDERSCHRAUBEN

Klemmlänge	Abmessung	Artikel Nummer
41 ... 44	M5x50	246.2151
46 ... 49	M5x55	246.2156
51 ... 54	M5x60	246.2160
56 ... 59	M5x65	246.2165
61 ... 64	M5x70	246.2171
66 ... 69	M5x75	246.2176
69 ... 72	M5x78	249.2003
71 ... 74	M5x80	246.2181
76 ... 79	M5x85	246.2185

Klemmlänge	Abmessung	Artikel Nummer
79 ... 82	M5x88	249.2006
81 ... 84	M5x90	246.2190
86 ... 89	M5x95	249.2004
91 ... 94	M5x100	246.2193
101 ... 104	M5x110	246.2191
111 ... 114	M5x120	246.2192

 Material: Stahl 8.8
 Oberfläche: verzinkt

STIFTSCHRAUBE M5XL...

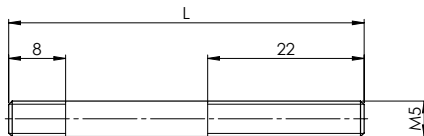

Klemmlänge	Abmessung	Artikel Nummer
83 ... 98	M5x112	224.2016
89 ... 104	M5x118	224.2025
95 ... 110	M5x124	224.2001
106 ... 121	M5x135	224.2023
113 ... 128	M5x142	224.2002
124 ... 140	M5x154	224.2003
136 ... 151	M5x165	224.2013
143 ... 158	M5x172	224.2004
154 ... 170	M5x184	224.2005
166 ... 181	M5x195	224.2011
173 ... 188	M5x202	224.2006
184 ... 200	M5x214	224.2007
196 ... 212	M5x226	224.2008
208 ... 223	M5x237	224.2028
219 ... 234	M5x248	224.2026
227 ... 242	M5x256	224.2020
246 ... 261	M5x275	224.2032
251 ... 266	M5x280	224.2030
292 ... 307	M5x321	224.2029

 Material: ETG100
 Oberfläche: brüniert

STIFTSCHRAUBE M5XL...K8

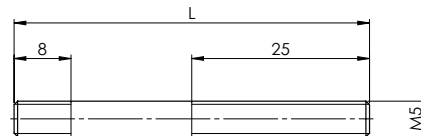

Klemmlänge	Abmessung	Artikel Nummer
74 ... 98	M5x112	224.2082
80 ... 104	M5x118	224.2084
86 ... 110	M5x124	224.2073
97 ... 121	M5x135	224.2083
104 ... 128	M5x142	224.2072
115 ... 140	M5x154	224.2074
127 ... 151	M5x165	224.2081
134 ... 158	M5x172	224.2075
145 ... 170	M5x184	224.2076
157 ... 181	M5x195	224.2080
164 ... 188	M5x202	224.2077
175 ... 200	M5x214	224.2078
187 ... 212	M5x226	224.2079
199 ... 223	M5x237	224.2085
229 ... 254	M5x268	224.2086
237 ... 261	M5x275	224.2087
262 ... 276	M5x280	224.2090
283 ... 307	M5x321	224.2088

Material: Rostfrei 1.4057